



## *Southern Lehigh School District Hopewell Elementary School*



### **PHASING PLAN**

#### **Phase 1: New Building Construction**

**Start:** June 1, 2015

**Substantial Completion:** August 1, 2016

### **WORK COMPLETED**

#### **Phase 1 – New Building Construction work consisting of:**

##### **Site Work**

- Complete installation of infiltration basin 33.
- Final tie in of sanitary, including coring under West Hopewell Road into manhole, completed.
- Installation of 2B stone on grade for Area A: 95% complete, gym and music room remain.
- Underground storm piping 25% complete.

##### **General Contractor**

- Concrete slab on grade completed for Area A: 90% complete
- Concrete slab on grade for Areas B and C: 100% complete
- Construction of reinforced CMU walls for gymnasium 100% completed.
- Cold formed metal Stud framing completion for B and C: 100% complete ( load bearing)
- Roof trusses for Areas B and C: 100% complete.
- Structural steel installation throughout entire building: 95% complete.
- Steel roof decking
  - Area B and C: 100% complete
  - Area A: 30% complete
- Roof insulation and substrate: 10% complete

### **WORK PROJECTED FOR DECEMBER 2015**

##### **Site Work**

- Continue working on underground storm piping system.
- Bring recently completed infiltration basin up to grade with placement of soil and final top soil over affected area.
- Clean mud from gym & music room and place clean 2B stone
- Install underground gas line into building in coordination with UGI.

##### **General Contractor**

- Complete concrete slab-on-grade in Area A.
- Finish setting both the steel and the glue lamb trusses ( all trusses complete)
- Begin spray foam insulation on exterior walls.
- Finish metal roof deck, roof insulation, substrate, and shingles.
- Begin interior cold formed steel framed walls (non-structural) in Areas A, B, & C.
- Begin laying brick and masonry veneer.
- Setting wood roof trusses for gym.
- Install metal roof decking, insulation & substrate and shingles on gym roof area.

**WORK COMPLETED (cont'd)****Plumbing Contractor**

- Completed all underground work within the building footprint, including installation of floor drains.
- Toilet and sink carriers have been set in the boys and girls gang bathrooms between Areas B and C.

**Electrical Contractor**

- Completed under-ground electrical feeder conduit install in Areas A, B, and C - 100% completed.
- Installation of under-ground branch conduit in Areas A, B, and C - 100% completed.
- CMU gymnasium walls electrical rough-in - 100% completed.
- Install several electrical panels in Area A.

**Mechanical Contractor**

- Drilling of geothermal wells to start back up around Thanksgiving with delivery of new 200' length loop piping. Previously completed work - 15%, including installation of casing and poly supply & return loop piping.

**WORK PROJECTED FOR DECEMBER  
2015 (cont'd)****Plumbing Contractor**

- Begin installation of sanitary vent piping lines.
- Begin installation of above ceiling water lines.

**Electrical Contractor**

- Continue in-wall electrical rough-in in Area A.
- Begin electrical rough-ins in areas B and C within interior framed walls.
- Complete underground feeder installation in Area A including feeder electrical duct bank.
- Begin main electric duct bank work feeding the building.
- Install switch gear in main mechanical room.
- Installation of junction boxes and begin pulling wire throughout building.

**Mechanical Contractor**

- Continue drilling of geothermal wells, including installation of casing and poly supply & return piping.
- Final coordination of BIM model used with other Primes to insure no system conflicts.

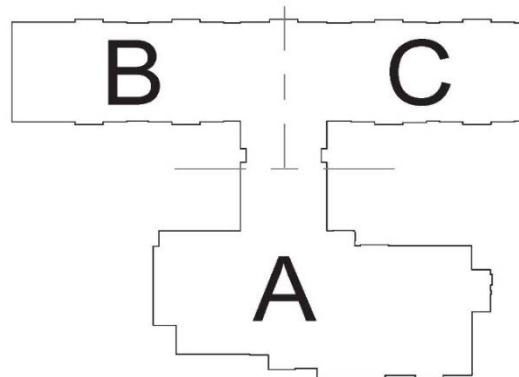
**Building Layout**



## Project Cost Summary

Contractor	Original Contract Amount	Change Orders to Date	Updated Contract Amount	Amount Paid to Date	Amount Remaining
Lobar (GC)	\$ 10,448,500.00	\$ -	\$ 10,448,500.00	\$ 2,723,380.67	\$ 7,725,119.33
JBM (MC)	\$ 2,630,000.00	\$ 395,241.00	\$ 3,025,241.00	\$ 334,008.00	\$ 2,691,233.00
Albarell (EC)	\$ 2,013,538.00	\$ -	\$ 2,013,538.00	\$ 68,669.33	\$ 1,944,868.67
DeWalt (PC)	\$ 835,000.00	\$ -	\$ 835,000.00	\$ 273,554.59	\$ 561,445.41
Sargent (EAC)	\$ 86,988.00	\$ -	\$ 86,988.00	\$ -	\$ 86,988.00
Air Balancing Engineers	\$ 62,150.00	\$ -	\$ 62,150.00	\$ -	\$ 62,150.00
Chrin	\$ 75,000.00	\$ -	\$ 75,000.00	\$ 874.80	\$ 74,125.20
Advantage - constr. testing	\$ 75,000.00	\$ -	\$ 75,000.00	\$ 17,879.63	\$ 57,120.37
<b>Total</b>	<b>\$ 16,226,176.00</b>	<b>\$ 395,241.00</b>	<b>\$ 16,621,417.00</b>	<b>\$ 3,418,367.02</b>	<b>\$ 13,203,049.98</b>
Contractor	Starting Allowance	Allowance Issued	Allowance Remaining		
Lobar (GC)	\$ 172,350.00	\$ (4,450.16)	\$ 176,800.16		
JBM (MC)	\$ 121,000.00	\$ -	\$ 121,000.00		
Albarell (EC)	\$ 102,979.00	\$ -	\$ 102,979.00		
DeWalt (PC)	\$ 40,125.00	\$ 9,462.05	\$ 30,662.95		
Sargent (EAC)	\$ 5,900.00	\$ -	\$ 5,900.00		
<b>Total</b>	<b>\$ 442,354.00</b>	<b>\$ 5,011.89</b>	<b>\$ 437,342.11</b>		